

## NORMAND PARCEL

### Normand Parcel

Certified Real Estate Broker AEO - D3341

514-237-8103

Other : 514-237-8103

Email : nparcel@videotron.ca

Website : <http://www.normandparcel.com>



## Saint-Adolphe-d'Howard

### Ch. du Lac-Wilson O.

Near ch. Parkview

# 19179729 - Source : IMMEUBLES GROUPE CANTOR, Real Estate Agency

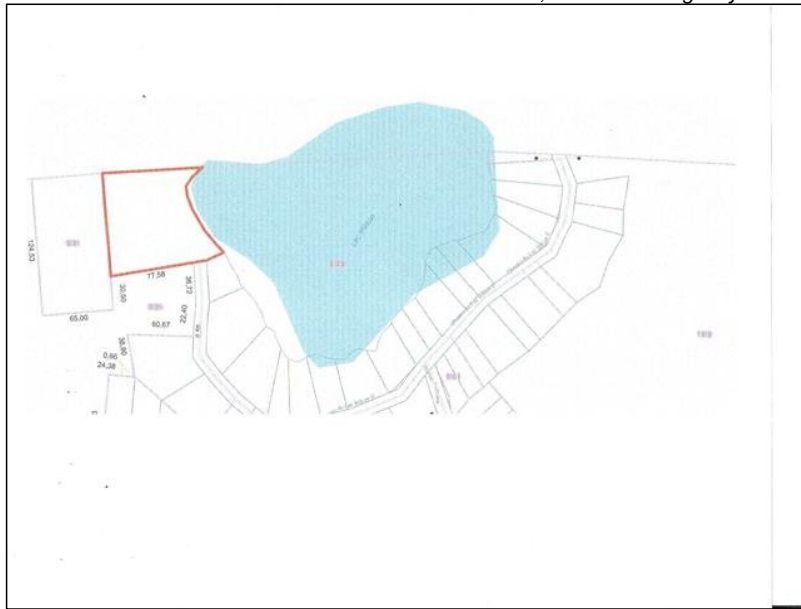

**For sale : 55 000 \$**

<b>Category</b>	Land / Lot
<b>Style</b>	Vacant lot

#### Lot

<b>Front</b>	106.6 meters
<b>Depth</b>	94.03 meters
<b>Area</b>	7721.8 square meters
<b>Water area name</b>	Lac Wilson

#### Evaluation (2018)

<b>Lot</b>	44 310 \$
------------	-----------

#### Expenses

	Monthly	Yearly
<b>Municipal Taxes (2018)</b>	37 \$	449 \$
<b>School taxes (2018)</b>	13 \$	150 \$
<b>Total:</b>	<b>50 \$</b>	<b>599 \$</b>

Beautiful waterfront lot, build your dream house in this peaceful country setting. Set between Morin Heights and St. Adolphe d'Howard in 'Domain Flamingo'

### Addenda

Any new certificate of location shall be at the buyers expense.

#### Features

<b>Distinctive features</b>	Waterfront : Lake, No neighbours in the back, Non navigable, Cul-de-sac, Lot with mixed wood, Wooded
<b>Proximity</b>	Golf, Cross-country skiing
<b>Sewage system</b>	None
<b>Topography</b>	Sloped
<b>View</b>	Panoramic, Water
<b>Water supply</b>	None
<b>Zoning</b>	Residential